

BURMA COMMERCE PARK

LYING IN THE NORTHEAST QUARTER OF
SECTION 19, TOWNSHIP 42 SOUTH, RANGE 43 EAST
CITY OF PALM BEACH GARDENS, PALM BEACH COUNTY, FLORIDA
PAGE 1 OF 2

JANUARY 27, 1997

COUNTY OF PALM BEACH) ss
STATE OF FLORIDA)
This Plat was filed for record at 9:19 A.M.
this 27 day of February 1997
and duly recorded in Plat Book No. 79
on page 42 and 43
DOROTHY H. WILKIN, Clerk of Circuit Court
by *[Signature]* D.C.

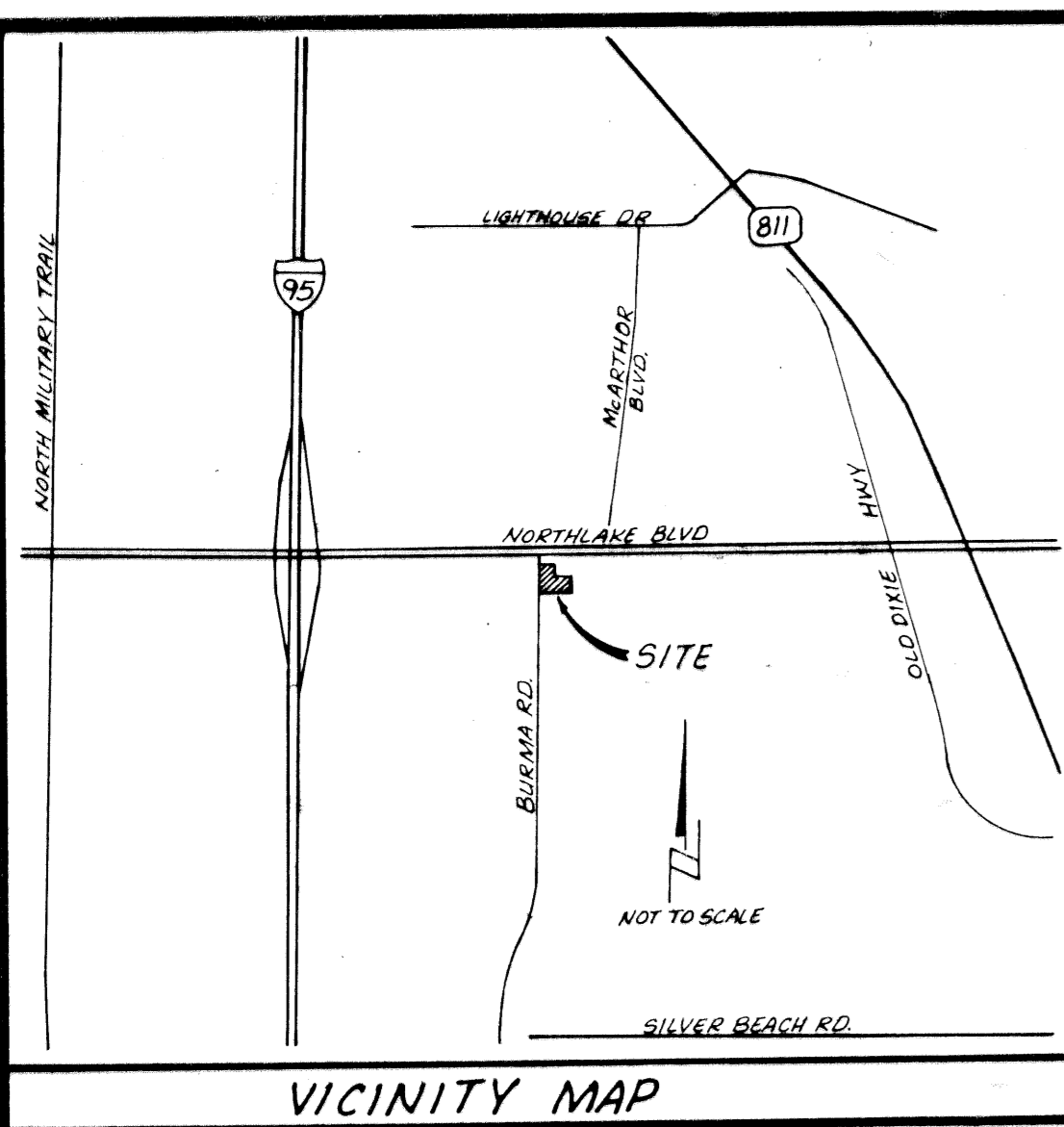
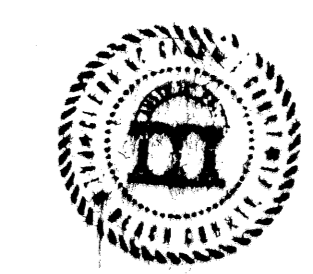

VICINITY MAP

TITLE CERTIFICATION

STATE OF FLORIDA
COUNTY OF *Palm Beach*

I, ALYS DANIELS, A DULY LICENSED ATTORNEY IN THE STATE OF FLORIDA WITH THE FIRM OF GARY, DYTRYCH & RYAN, DO HEREBY CERTIFY THAT I HAVE EXAMINED THE TITLE TO THE PROPERTY DESCRIBED HEREON (THE "PROPERTY"); AND THAT I FIND THE FEE SIMPLE TITLE TO THE PROPERTY IS VESTED IN

PALM BEACH ASSETS, L.C., A FLORIDA LIMITED LIABILITY COMPANY

THAT THE CURRENT TAXES HAVE BEEN PAID; THAT THERE ARE NO MORTGAGES OF RECORD; AND THAT THERE ARE ENCUMBRANCES OF RECORD AND UNRECORDED MATTERS BUT THOSE ENCUMBRANCES AND UNRECORDED MATTERS DO NOT PROHIBIT THE CREATION OF THE SUBDIVISION DEPICTED BY THIS PLAT.

GARY, DYTRYCH & RYAN
701 U.S. HIGHWAY NO. 1
SUITE 402
N. PALM BEACH, FL. 33408

DATE: *2/6/97*

BY: *[Signature]*
ALYS DANIELS
Florida Bar No. 354600

LEGAL DESCRIPTION

PART OF THE NORTHEAST 1/4 OF SECTION 19, TOWNSHIP 42 SOUTH, RANGE 43 EAST, PALM BEACH COUNTY, FLORIDA, BEING MORE PARTICULARLY DESCRIBED AS FOLLOWS:

FROM THE NORTHWEST CORNER OF SAID NORTHEAST 1/4 OF SECTION 19 RUN S1°32'37"W ALONG THE WEST LINE OF SAID NORTHEAST 1/4 OF SECTION 19 A DISTANCE OF 375.00 FEET; THENCE S88°26'21"E ALONG A LINE BEING 375 FEET SOUTH OF AND PARALLEL WITH THE NORTH LINE OF THE NORTHEAST 1/4 OF SECTION 19 A DISTANCE OF 30 FEET TO A POINT ON THE EAST RIGHT-OF-WAY LINE OF BURMA ROAD, SAID POINT ALSO BEING THE POINT OF BEGINNING OF THE HEREIN DESCRIBED PARCEL; THENCE CONTINUE S88°26'21"E PARALLEL WITH AND 375 FEET SOUTH OF THE NORTH LINE OF THE NORTHEAST 1/4 A DISTANCE OF 136.68 FEET; THENCE S1°30'59"W A DISTANCE OF 263.46 FEET; THENCE S88°26'21"E PARALLEL WITH THE NORTH LINE OF THE NORTHEAST 1/4 OF SECTION 19 A DISTANCE OF 164.99 FEET; THENCE S1°32'37"W ALONG A LINE BEING 331.80 FEET EAST OF AND PARALLEL WITH THE WEST LINE OF AFORESAID NORTHEAST 1/4 OF SECTION 19 A DISTANCE OF 211.56 FEET; THENCE N88°26'21"W ALONG A LINE BEING 850 FEET SOUTH OF AND PARALLEL WITH SAID NORTH LINE OF THE NORTHEAST 1/4 OF SECTION 19 A DISTANCE OF 301.80 FEET TO A POINT ON A LINE BEING 30' EAST OF THE WEST LINE OF SAID NORTHEAST 1/4 OF SECTION 19; THENCE N1°32'37"E PARALLEL WITH SAID WEST LINE OF THE NORTHEAST 1/4 OF SECTION 19 A DISTANCE OF 475.00 TO THE POINT OF BEGINNING.

CONTAINING 2.293 ACRES, MORE OR LESS.

CERTIFICATE OF APPROVALS BY CITY OF PALM BEACH GARDENS COUNTY OF PALM BEACH, FLORIDA

THIS IS HEREBY APPROVED FOR RECORD THIS *20th* DAY OF *February* 1997

BY: *[Signature]*
JOSEPH R. RUSSO - MAYOR

ATTEST: *[Signature]*
LINDA V. KOSIER - CITY CLERK

CITY ENGINEER
BY: *[Signature]*
LENNART E. LINDAHL P.E. - CITY ENGINEER

DEDICATION

STATE OF FLORIDA,
COUNTY OF PALM BEACH
CITY OF PALM BEACH GARDENS

KNOW ALL MEN BY THESE PRESENTS, THAT THE LIMITED LIABILITY COMPANY NAMED BELOW, BEING THE OWNER IN FEE SIMPLE OF THE LANDS DESCRIBED IN THIS PLAT OF BURMA COMMERCE PARK, HEREBY DEDICATES SAID LANDS AND PLAT FOR THE USES AND PURPOSES THEREIN EXPRESSED.

IN WITNESS WHEREOF, HAS CAUSED THESE PRESENTS TO BE SIGNED AND ATTESTED TO BY THE OFFICER NAMED BELOW:

PALM BEACH ASSETS, L.C., A FLORIDA LIMITED LIABILITY COMPANY

BY: *[Signature]*
JOHN C. BILLS - PRESIDENT

ATTEST:
[Signature]

SIGNED AND SEALED IN THE PRESENCE OF:
[Signature]
[Signature]

SURVEYOR'S CERTIFICATION

STATE OF FLORIDA } s.s.
COUNTY OF PALM BEACH }

I HEREBY CERTIFY THAT THE PLAT SHOWN HEREON IS A TRUE AND CORRECT REPRESENTATION OF A SURVEY MADE UNDER MY RESPONSIBLE DIRECTION AND SUPERVISION AND THAT SAID SURVEY IS ACCURATE TO THE BEST OF MY KNOWLEDGE AND BELIEF; THAT PERMANENT REFERENCE MONUMENTS (P.R.M.'S) HAVE BEEN PLACED AS REQUIRED BY LAW AND THAT PERMANENT CONTROL POINTS (P.C.P.'S) WILL BE SET AS REQUIRED BY LAW (NO P.C.P.'S REQUIRED) AND AND FURTHER THAT THE SURVEY DATA COMPLIES WITH ALL THE REQUIREMENTS OF CHAPTER 177 FLORIDA STATUTES, AS AMENDED, AND ORDINANCES OF THE CITY OF PALM BEACH GARDENS, PALM BEACH COUNTY, FLORIDA.

[Signature]
WILLIAM E. POWELL, PROFESSIONAL SURVEYOR & MAPPER
FLORIDA REGISTRATION NO. 1812

DATE: *Feb. 12, 1997*

NOTICE: THERE MAY BE ADDITIONAL RESTRICTIONS THAT ARE NOT RECORDED ON THIS PLAT THAT MAY BE FOUND IN THE PUBLIC RECORDS OF THIS COUNTY.

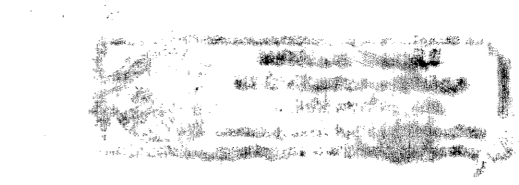

THIS PLAT PREPARED BY:
WILLIAM E. POWELL, P.L.S.

CHP
CANTELOU, HERRERA & POWELL, INC.
ARCHITECTURE • ENGINEERING • SURVEYING • PLANNING
1370 SARNO ROAD, SUITE G, MELBOURNE, FLORIDA 32935
(407) 259-1525 L.B. # 6609 Fax 407-259-4185

SUBDIVISION: Burma Commerce Park
 BOOK: 79
 FLOOD ZONE: FLOOD-PLAIN
 QUAD: 42
 SE: 42
 PUD NAME: City of Palm Beach

TAZ 107